

HARBOUR STATION TRUSS LOAD CAPACITY

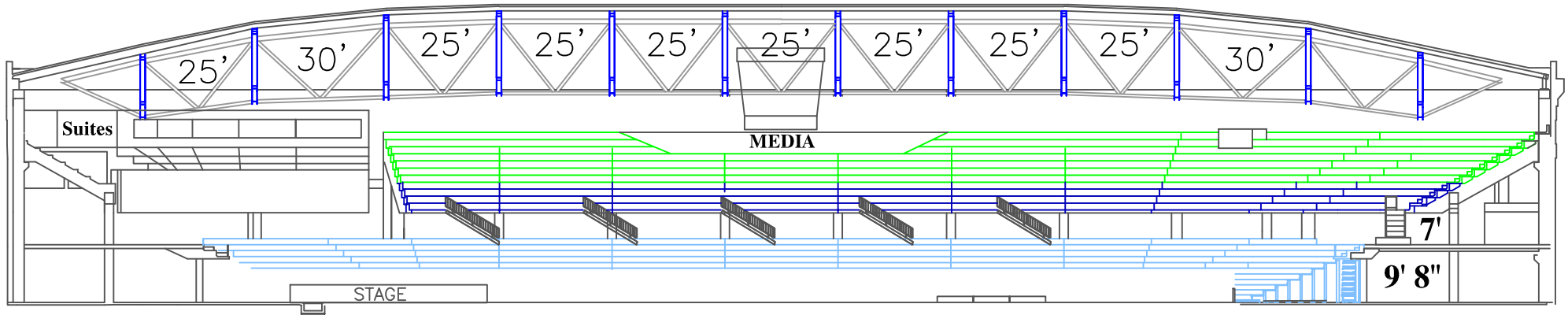

EAST / WEST

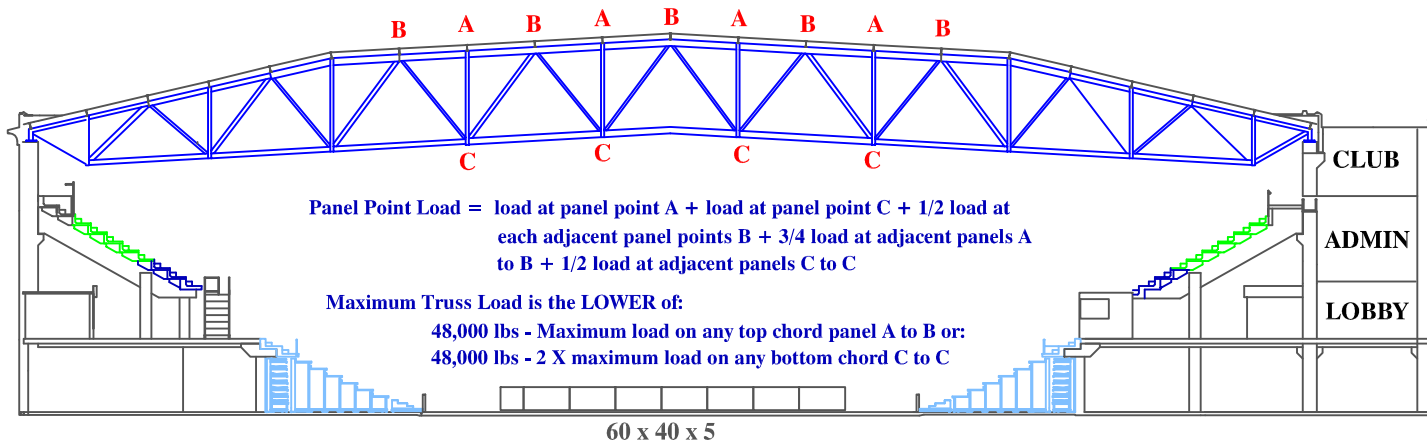

- A top chord major panel point
- B top chord panel point intermediate
- C bottom chord panel point

Maximum Panel Point Load is 12,000 lbs

**** If more than 10,000 lbs placed anywhere on truss, REVIEW by P.Eng required****

As per Communication:
 Johnson Engineered Solutions Ltd.
 Saint John NB
 506-635-4996
 February 21 2006

NORTH / SOUTH